



PLAT OF SURVEY
-OF-

LOT 54 OF SHOREWOOD SUBDIVISION, BEING
LOCATED IN PART OF THE SOUTHEAST 1/4
OF SECTION 10, THE SOUTHWEST 1/4 OF
SECTION 11, THE NORTHWEST 1/4 OF SECTION
14 AND THE NORTHEAST 1/4 OF SECTION 15,
TOWNSHIP 4 NORTH, RANGE 18 EAST, TOWN
OF EAST TROY, WALWORTH COUNTY,
WISCONSIN

SURVEY FOR: CAROL HAYNES

SURVEY LOCATION: W1012 SHOREWOOD DRIVE

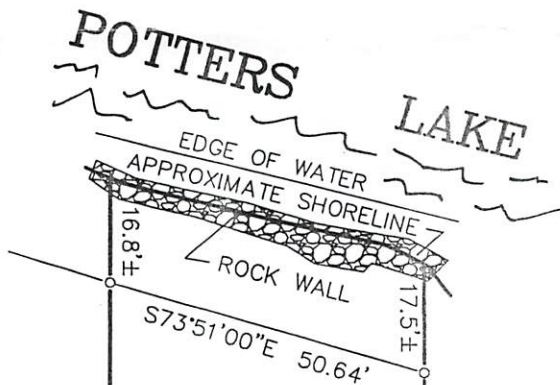

BEARINGS HEREON RELATE TO THE
NORTH LINE OF SHOREWOOD DRIVE,
ASSUMED BEARING WEST

REFER TO A CURRENT TITLE
REPORT FOR EASEMENTS OR
RESTRICTIONS WHICH MAY AFFECT
THE USE OF THIS SITE.

LEGEND

- FOUND IRON PIPE
- ✂ SET IRON PIPE

GRAPHIC SCALE



SCALE: 1" = 30'

150.00'

WEST 50.00'

SHOREWOOD DRIVE

N00°08'49"E
(NORTH)

195.63'

212.4'±

S00°16'13"E
(S0°18'E)

181.55'

199.0'±

PRIVATE ACCESS

30'

IMPROVEMENTS
HEREON
NOT LOCATED

"I hereby certify that I have surveyed the above described
property and that the above map is a correct representation thereof
and shows the size and location of the property, its exterior
boundaries, the location of all visible structures and dimensions
of all principal buildings thereon, boundary fences, apparent
easements, roadways and encroachments, if any."

"This survey is made for the use of the present owners of the
property, and those who purchase, mortgage, or guarantee the
title thereto within one year from date hereof."

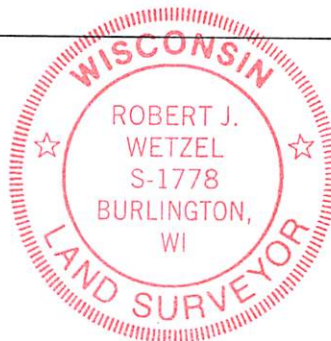

THIS IS NOT AN ORIGINAL PRINT
UNLESS THIS SEAL IS RED.

Robert J. Wetzel
ROBERT J. WETZEL S-1778

OCTOBER 20, 2021
DATE

10527
JOB NUMBER



B.W. SURVEYING, INC.

412 N. PINE STREET
BURLINGTON, WI 53105
(262)-767-0225

PS-51

418-2832